



Seat Belts

Front Seat Belt Replacement

SRS wire harnesses are routed near the retractor.

⚠ WARNING All SRS wire harnesses and connectors are colored yellow. Do not use electrical test equipment on these circuits.

CAUTION:

- Be careful not to damage the SRS wire harnesses when servicing the retractor.
- Remove the short connector (RED) from the connector holder and disconnect the SRS wire harness connector, then connect the short connector (RED) to the seat belt pretensioner connector.

NOTE: To prevent contamination, wrap the SRS wire harness connector with a protective cover.

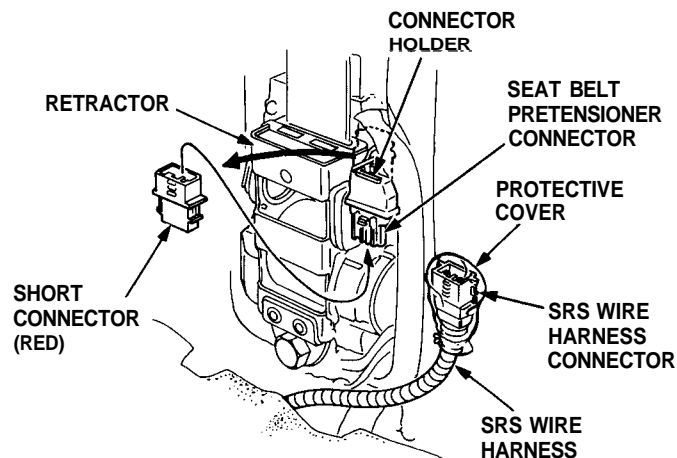

CAUTION: Check the seat belts for damage and replace them if necessary. Be careful not to damage them during removal and installation.

1. Remove the front seat (see page 20-47) and center pillar lower trim (see page 20-45).
2. Remove all three anchor bolts, the retractor bolt and retractor mounting bolt, then remove the seat belt and seat belt buckle.

NOTE: When removing the anchor bolts and retractor bolt, use a 17 mm socket or box-end wrench.

CAUTION: When removing the retractor, do not touch the belt pretensioner.

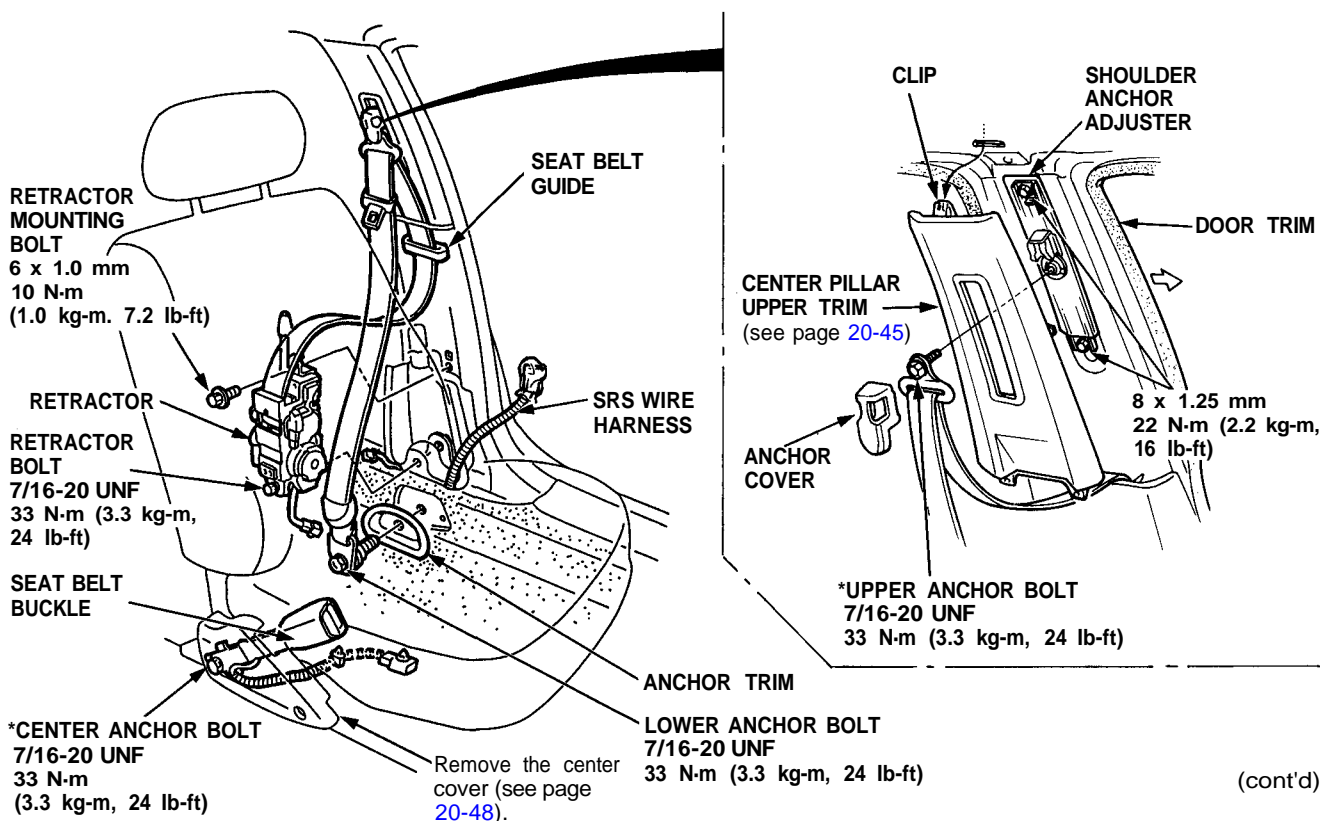

(cont'd)

Seat Belts

Front Seat Belt Replacement (cont'd)

Anchor bolt construction:

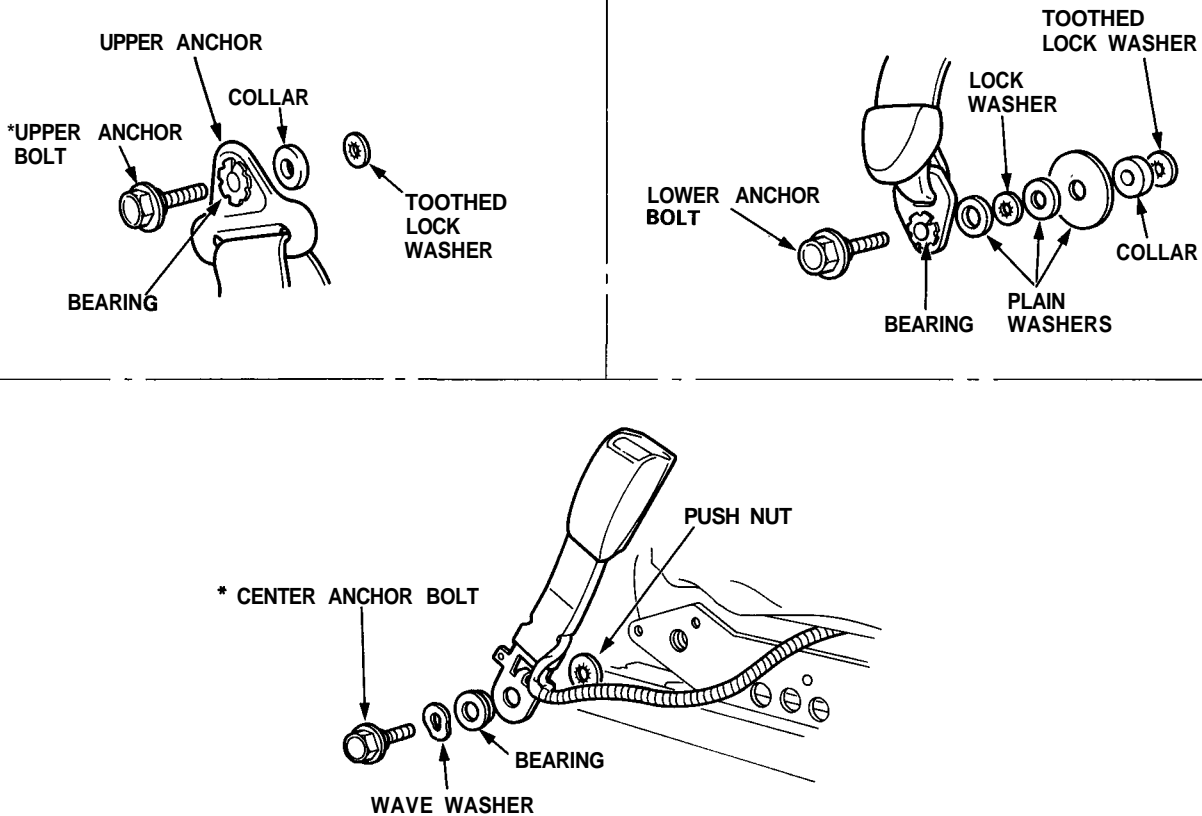

3. Check that the retractor locking mechanism functions as described on page [20-70](#).

NOTE: When storage of the seat belts is necessary, store them in a place free from water, oil, grease, heat and direct sunlight.

4. Installation is the reverse of the removal procedure.

NOTE:

- Make sure you assemble the washers and collars on the upper, center and lower anchor bolts as shown.
- Before reinstalling the center pillar lower trim, make sure there are no twists or kinks in the seat belts.
- On reassembly, replace the upper and center anchor bolts (*) and use liquid thread lock.